

# Regional Measure 3 July 2023 Capital Allocations

**Programming and Allocations Committee**

**July 12, 2023**

**Craig Bosman**



**METROPOLITAN  
TRANSPORTATION  
COMMISSION**

# RM3 Capital Program

- 35 named projects in statute
- \$4.45 billion total

RM3 Capital Projects by Mode

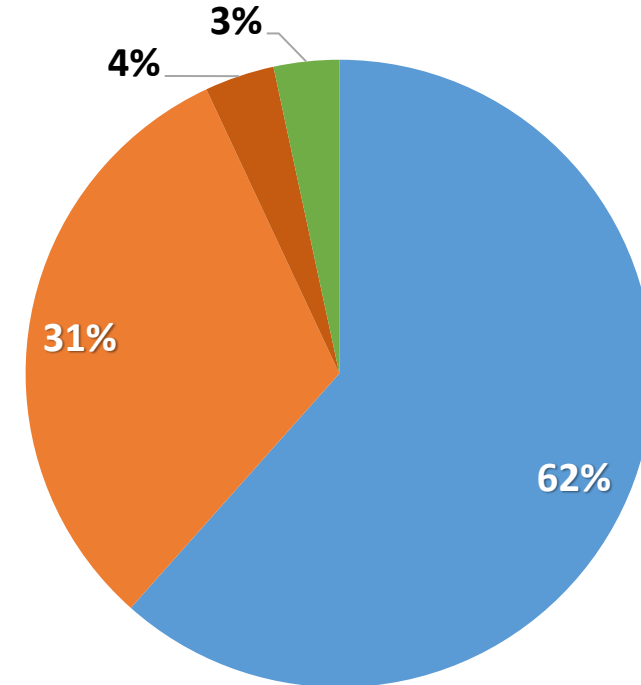

- Transit, 62%
- Roads/Highway, 31%
- Multimodal, 4%
- Bike/Ped, 3%

# RM3 Capital Allocations to Date

- In May, Commission directed staff to begin accepting RM3 capital allocation requests for action starting in June
- In June, Commission approved 9 allocations totaling \$272 million to projects that had received RM3 Letters of No Prejudice (LONPs)
- This month, staff recommends 8 allocations totaling \$379 million, including 6 projects with LONPs and 2 without

# Recommended July Allocations

Project Sponsor	Project Title	LONP Amount (\$M)	Allocation Request Amount (\$M)
VTA	Eastridge to BART Regional Connector	-	\$130.0
Alameda CTC	I-680/SR-84 Interchange Reconstruction Project	\$85.0	\$85.0
Alameda CTC	I-680 Southbound Express Lane from SR-84 to Alcosta Blvd.	\$80.0	\$80.0
Alameda CTC	7th Street Grade Separation East	\$55.0	\$55.0
Solano TA	SR 37 and Fairgrounds Drive Interchange	-	\$15.0
Alameda CTC	SR-262 (Mission Blvd.) Cross Connector	\$10.0	\$10.0
San Mateo CTA	Highway 101/State Route 92 Interchange Direct Connector Project	\$2.0	\$2.0
Solano TA	North Bay Transit Access Improvements: Solano Rail Hub	-	\$2.0
Total		\$232.0	\$379.0

# Eastridge to BART Regional Connector

- \$130M allocation for construction
- 2.4-mile extension of VTA Light Rail from Alum Rock to Eastridge
- RM3 completes funding plan along with VTA Measure A and state investment
- Construction award expected end of 2023
- Project expected to be complete in late 2028



# I-680/SR-4 Interchange Reconstruction

- \$85M allocation for construction
- Reconstructs and modernizes interchange
- RM3 LONP allowed project to advance
- Construction underway and expected to be complete in early 2025



# I-680 Southbound Express Lane

- \$80M allocation for construction
- Under Regional Express Lanes category
- Extends express lanes by 9 miles
- RM3 LONP and funding leverages \$25M in SB1 funds
- BATA and MTC also advanced funds to keep project on track
- Construction underway and expected to be complete in late 2025



# 7<sup>th</sup> Street Grade Separation East

- \$55M allocation for construction
- Under Goods Movement and Mitigation category
- Realignment and reconstruction for safety and state of good repair
- RM3 LONP and funding leverages \$175M in SB1 Trade Corridor Enhancement Program funds
- Construction underway and expected to be complete in late 2026

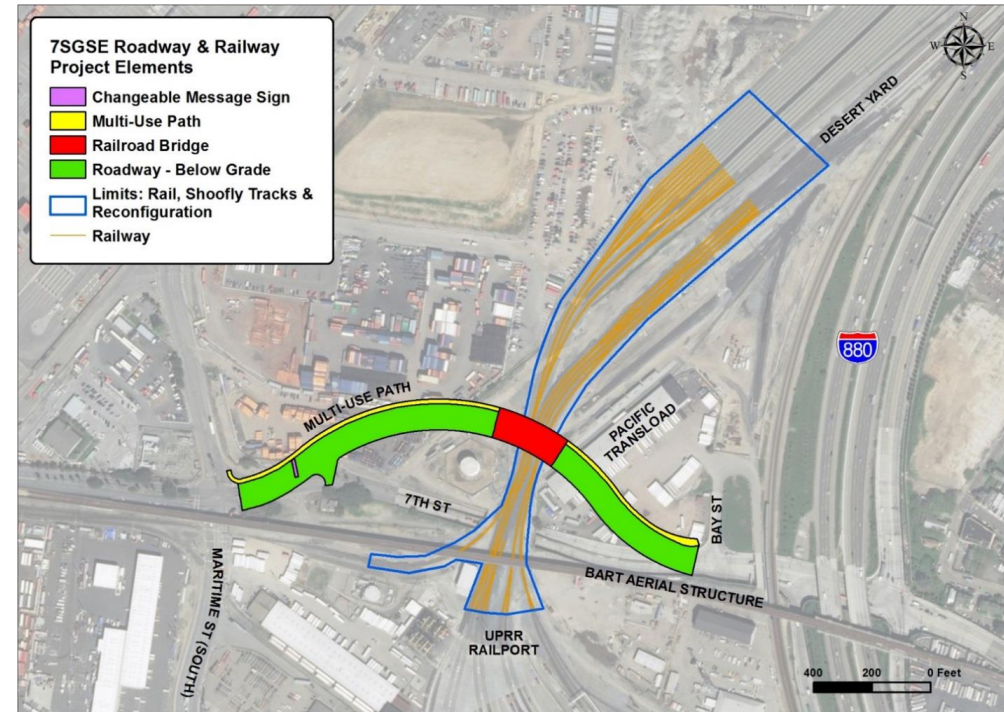



# SR-37 and Fairgrounds Drive Interchange

- \$15M allocation for construction
- Under SR-37 Improvements category
- New interchange design and improvements on Fairgrounds Drive

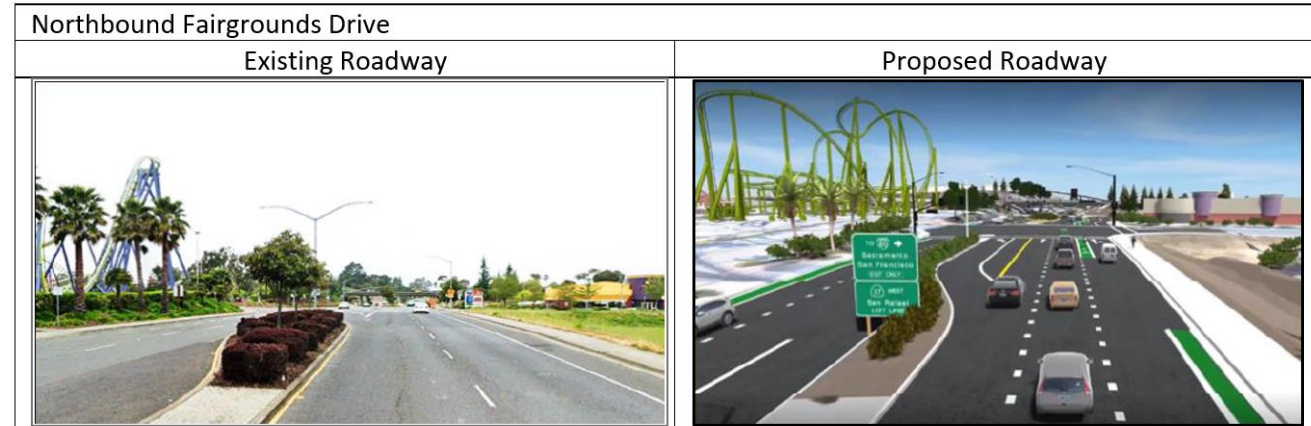

# Pre-Construction Phase Allocations

- **SR-262 (Mission Blvd) Cross Connector**
  - \$10M for environmental phase, consistent with LONP
  - Project will assess a grade separation for SR-262 from Mohave Drive and Warm Springs Boulevard in Fremont
- **Solano Rail Hub**
  - Under North Bay Transit Access Improvements category, \$2M for environmental phase
  - Project goal is improve access to the Suisun-Fairfield Capitol Corridor/Amtrak station and connections between Fairfield and Suisun City
- **Highway 101/SR-92 Interchange Direct Connector**
  - \$2M for environmental phase, consistent with LONP
  - Project will provide direct connector ramps at interchange